

Steps to Apply for Health Science Programs (effective September 2023)

1.

Go to estorm.swic.edu and log in using your SWIC Student ID and password:

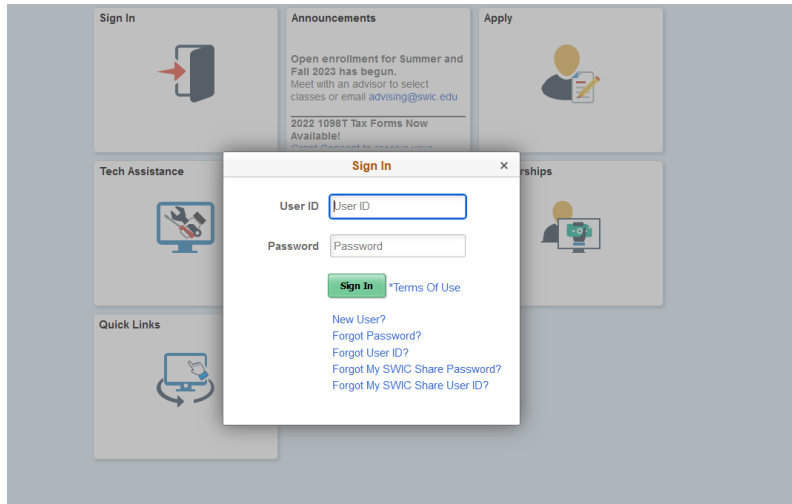

2.

Click the “Program Applications” tile on your Student Center Homepage:

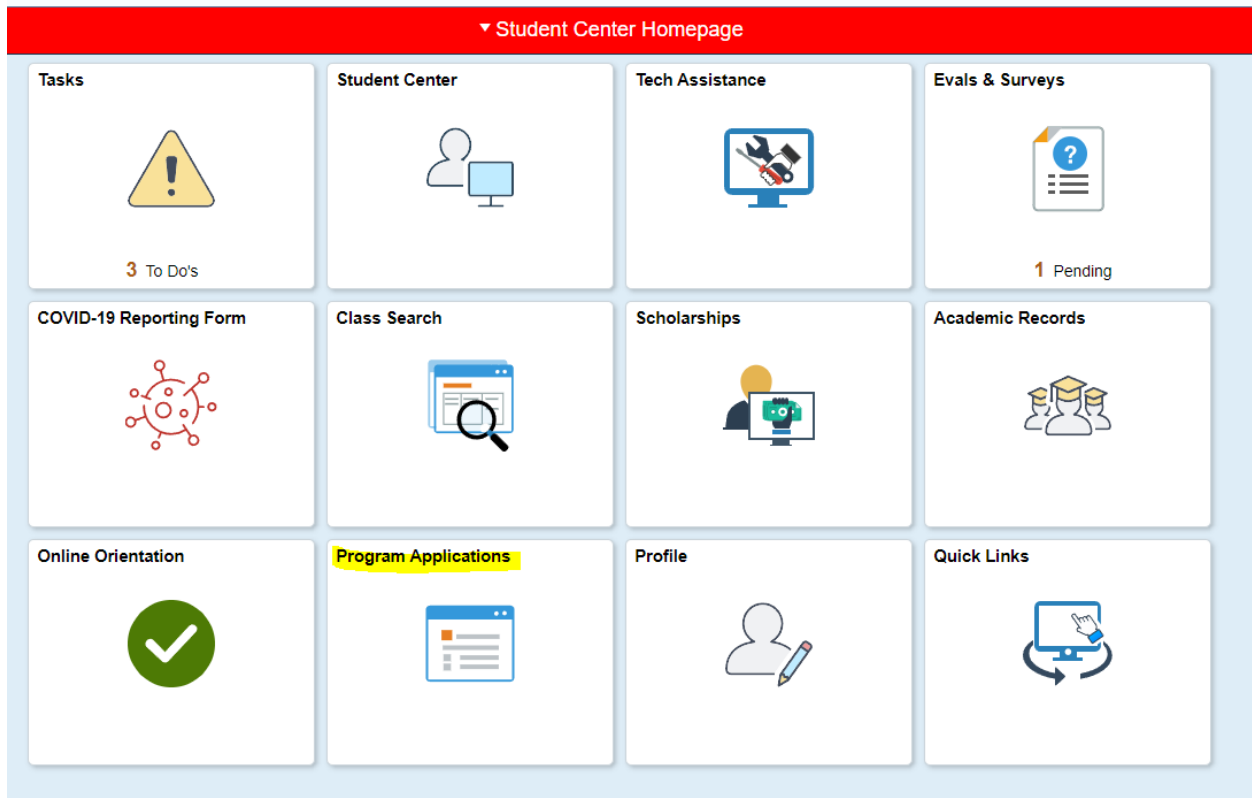

3.

From the drop-down bar, select the program you are interested in applying for.

The screenshot shows the 'Program Applications' page. On the left is a sidebar with 'Program Applications' selected. The main content area has a red header with 'Program Applications' and navigation icons. Below the header, there's a dropdown menu with the following options: Advanced Nursing Education (AAS-0025), Diagnostic Medical Sonography (CERTE-028B), Medical Laboratory Technologies (AAS-0022), Nursing Education (AAS-0025), Paramedic (CERTE-068B), Physical Therapist Assistant (AAS-0027), Practical Nursing (CERTE-025C), Radiologic Technology (AAS-0028), and Respiratory Care (AAS-020A). Below the dropdown, there is explanatory text about the application process.

4.

If the program has active applications, the opening date and deadline to apply will be listed under “Upcoming Cohorts.” Click the “Apply Now” button for the cohort you wish to apply for.

- PLEASE NOTE: only one active application per admission term is allowed.

The screenshot shows the 'Program Applications' page with 'Nursing Education (AAS-0025)' selected in the dropdown menu. Below the dropdown, there is a 'Learn More' button and a section titled 'Upcoming Cohorts' with a table. The table has columns for Cohort, Admit Term, Application Deadline, and Application Opens. There are two rows of cohorts, each with an 'Apply Now' button.

Cohort	Admit Term	Application Deadline	Application Opens	
Nursing Education - Fall 2024 - Belleville	2024 Fall	12/01/2023	09/01/2023	Apply Now
Nursing Education - Fall 2024 - Granite City	2024 Fall	12/01/2023	09/01/2023	Apply Now

5.

Complete the application by following the instructions on the screen, using “View Unofficial Transcript” to enter coursework and grades. Criterion that is marked “Required” must be completed before the required deadline. Criterion that is marked “Optional” does not need to be completed by the required deadline, but it may still be required as part of your degree requirements. Please review application planning guide for more information.

Req/Opt	Criterion	Instructions	Points Available	Completed	Comment
1 Required	Proof of Residency	By checking the box, you acknowledge that you have established residency with SWIC. If your address is out of district, please provide inter-district cooperative agreement from the college located in your district before the deadline.	0.00	<input type="checkbox"/>	
2 Required	High School Transcript/GED	By checking the box, you acknowledge that your high school/GED transcript is on file. If not, you acknowledge that you will submit an official copy before the deadline.	0.00	<input type="checkbox"/>	
3 Required	College Transcript	By checking the box, you acknowledge that official transcripts from ALL colleges attended must be submitted to SWIC before the deadline. In the comment, please indicate which colleges you've attended other than SWIC. (If you've only attended SWIC, please check the box and leave comment blank.)	0.00	<input type="checkbox"/>	
4 Required	Transfer Evaluation Request	If you are using coursework from another college, please use "Evaluate Transfer Credit" tab on previous screen to submit an evaluation request. By checking the box, you acknowledge that the request has been submitted OR that you are not using credits from anywhere other than SWIC.	0.00	<input type="checkbox"/>	
5 Required	COVID-19 Vaccination	By checking the box, you understand that, if accepted into the program, the COVID-19 vaccination is required and no exceptions will be made.	0.00	<input type="checkbox"/>	
6 Required	Biology Prerequisite	In the comment, please indicate your most recent Biology course and the grade received. If course is in-progress for Fall 2023 semester, please put "In-Progress."	4.00	<input type="checkbox"/>	
7 Required	Chemistry Prerequisite	In the comment, please indicate your most recent Chemistry course and the grade received. If course is in-progress for Fall 2023 semester, please put "In-Progress."	4.00	<input type="checkbox"/>	
8 Required	Algebra Prerequisite	In the comment, please indicate your most recent Algebra course and the grade received. If course is in-progress for Fall 2023 semester, please put "In-Progress."	4.00	<input type="checkbox"/>	
9 Required	TEAS fee payment	By checking the box, you acknowledge that a mandatory \$65 testing fee must be paid with the Business Office before December 1. If plan to use TEAS scores from a different institution, please check box and indicate in the comment.	0.00	<input type="checkbox"/>	
10 Required	TEAS score	By checking the box, you acknowledge that your TEAS score will be recorded and points will be updated by an evaluator after you take the exam in January/February 2024.	8.00	<input type="checkbox"/>	
11 Required	Completion of HRO 100 and HRO 120 before program start date.	By checking the box, you acknowledge that these two courses must be completed before Fall Nursing courses begin.	0.00	<input type="checkbox"/>	

7.

If you are using coursework from an institution other than SWIC, please use the “Evaluate Transfer Credit” tab on the left side of the screen to submit a request for Records to evaluate your transcript. Official transcripts from the institution you attended must be on file by the deadline. If your application requires extra documentation, please use “Upload Documents” to submit the appropriate documentation.

- NOTE: Official high school and college transcripts must still be submitted to SWIC by the application deadline. Transcripts that are uploaded by the students are considered unofficial.

Req/Opt	Criterion	Instructions	Points Available	Completed	Comment
1 Required	Proof of Residency	By checking the box, you acknowledge that you have established residency with SWIC. If your address is out of district, please provide inter-district cooperative agreement from the college located in your district before the deadline.	0.00	<input type="checkbox"/>	
2 Required	High School Transcript/GED	By checking the box, you acknowledge that your high school/GED transcript is on file. If not, you acknowledge that you will submit an official copy before the deadline.	0.00	<input type="checkbox"/>	
3 Required	College Transcript	By checking the box, you acknowledge that official transcripts from ALL colleges attended must be submitted to SWIC before the deadline. In the comment, please indicate which colleges you've attended other than SWIC. (If you've only attended SWIC, please check the box and leave comment blank.)	0.00	<input type="checkbox"/>	
4 Required	Transfer Evaluation Request	If you are using coursework from another college, please use "Evaluate Transfer Credit" tab on previous screen to submit an evaluation request. By checking the box, you acknowledge that the request has been submitted OR that you are not using credits from anywhere other than SWIC.	0.00	<input type="checkbox"/>	
5 Required	COVID-19 Vaccination	By checking the box, you understand that, if accepted into the program, the COVID-19 vaccination is required and no exceptions will be made.	0.00	<input type="checkbox"/>	
6 Required	Biology Prerequisite	In the comment, please indicate your most recent Biology course and the grade received. If course is in-progress for Fall 2023 semester, please put "In-Progress."	4.00	<input type="checkbox"/>	
7 Required	Chemistry Prerequisite	In the comment, please indicate your most recent Chemistry course and the grade received. If course is in-progress for Fall 2023 semester, please put "In-Progress."	4.00	<input type="checkbox"/>	
8 Required	Algebra Prerequisite	In the comment, please indicate your most recent Algebra course and the grade received. If course is in-progress for Fall 2023 semester, please put "In-Progress."	4.00	<input type="checkbox"/>	
9 Required	TEAS fee payment	By checking the box, you acknowledge that a mandatory \$65 testing fee must be paid with the Business Office before December 1. If plan to use TEAS scores from a different institution, please check box and indicate in the comment.	0.00	<input type="checkbox"/>	
10 Required	TEAS score	By checking the box, you acknowledge that your TEAS score will be recorded and points will be updated by an evaluator after you take the exam in January/February 2024.	8.00	<input type="checkbox"/>	
11 Required	Completion of HRO 100 and HRO 120 before program start date.	By checking the box, you acknowledge that these two courses must be completed before Fall Nursing courses begin.	0.00	<input type="checkbox"/>	

8.

When finished completing the application, be sure to read the “Application Agreement” and click the button at the bottom to agree to the terms and conditions:

Application Agreement

By selecting the indicator below, I affirm that:

1. I have read and understand the admission requirements and selection process for this program as documented in the college catalog, application planning guide, and information provided within this application (including possible participation in a background check and/or drug testing).
2. I understand that the College will exclusively contact me through my student.swic.edu email account regarding this application. If I do not receive an acknowledgement email within 10 working days of my submission, it is my responsibility to resolve the matter by contacting the Enrollment Services office.
3. I recognize that all supporting documentation must be received by the College prior to the application deadline to be considered towards this application.
4. I realize that Submission and Withdraw of this application are irrevocable actions and will prohibit my ability to edit this application.
5. Points displayed and/or awarded for this application do not indicate or imply an offer for admission to this cohort.
6. If an offer is extended to me and I do not respond by the specified due date, the college will assume I have declined the offer. The decision to decline an offer, explicitly or implied, is irrevocable.

For questions or concerns regarding this agreement, contact Enrollment Services at 618-235-2700, ext. 7336.

I Agree to the above Terms and Conditions No

9.

Hit “Save” to save your application, then hit “Submit” when you’re ready for it to be evaluated by a health science evaluator:

Program Applications

Applicant Mruzik, Stephen Jeffrey

Application Deadline 12/01/2023

Cohort Nursing Education - Fall 2024 - Belleville

Program Nursing Education

Admit Term 2024 Fall

Max Seats 90

[Planning Guide](#) [Save](#) [Submit](#) [Delete](#)

10.

Upon submitting the application, you are required to periodically check your SWIC student email for any updates regarding your application. It is your responsibility to ensure that all required items are received by the application deadline.